

matte photo paper

Instructions

Before Printing

- Only print using an inkjet or laser printer.
- Handle paper by the edges to avoid getting fingerprints on printable surfaces.

TIP: Print your photo or project on plain paper first to ensure correct size and image position. (Use Fast or Draft mode to conserve ink.)

Printing

1. Load paper into tray according to your printer's manual.

TIP: We recommend single-sheet feeding rather than stacking in tray.

2. Select Print within menu.
3. Click Preferences, Properties or Options button (depending on your printer):
 - Choose 'Portrait' or 'Landscape' Orientation and 'Letter' Size.
 - Set Media type to Matte Coated/Presentation Papers.
 - Set Quality setting to Normal.

TIP: Refer to your printer manual for specific settings for your printer model.

4. If printing second side, load according to your printer type shown in diagram.

Front Loading Printers

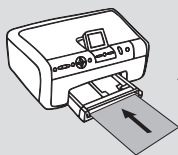

Load with
printed side
facing up

Top Loading Printers

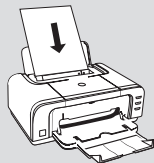

Load with
blank side
facing forward

Storage

- Store paper in packaging, flat and away from moisture and humidity.
- Avoid exposing printed or unprinted paper to bright lights or direct sunlight for extended periods of time.