

high gloss photo paper

Instructions

Before Printing

- Only print using an inkjet printer.
- Handle paper by the edges to avoid getting fingerprints on glossy printable surface.

TIP: Print your photo or project on plain paper first to ensure correct size and image position. (Use Fast or Draft mode to conserve ink.)

Printing

1. Load paper into tray according to your printer's manual.

TIP: We recommend single-sheet feeding rather than stacking in tray.

Front Loading Printers

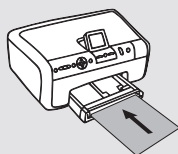

Load with
glossy side
facing down

Top Loading Printers

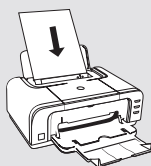

Load with
glossy side
facing forward

2. Select Print within menu.
3. Click Preferences, Properties or Options button (depending on your printer):
 - Choose 'Portrait' or 'Landscape' Orientation and 'Letter' Size.
 - Set Media type to Premium or Advanced Photo Papers.

TIP: Refer to your printer manual for specific settings for your printer model.

Storage

- Store paper in packaging, flat and away from moisture and humidity.
- Avoid exposing printed or unprinted paper to bright lights or direct sunlight for extended periods of time.